

1. Plug in the power and wait for a few seconds until hearing the "Ready for WiFi configuration".

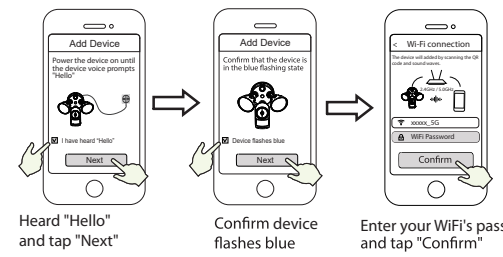

Tips: If you didn't hear the voice prompt, open the port cover on the back of the camera. Press and hold the Reset button for about 10 seconds to reset the camera.

2. Make sure that your smart phone is connected to your WiFi router.

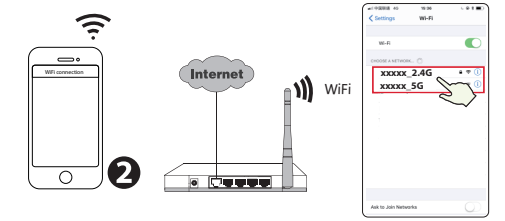

6. Please scan the QR code on the phone screen with the camera, then you will hear a voice prompt say "WiFi connecting". Select the checkbox and tap "Next".

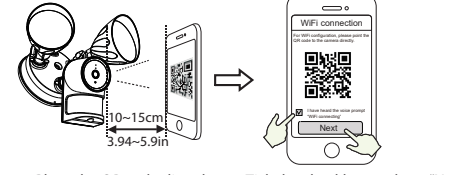

Tips: Please place the QR code on the phone screen about 10 to 15cm (3.94 to 5.9in) away, and if you encounter difficulties you can try to move the screen slowly around 10 - 15cm (3.94 - 5.9in).

8. Tapping on the play button in the video box will jump to the "Camera Login" setting interface.

For your security, please set a new username and password for your camera before viewing live video.

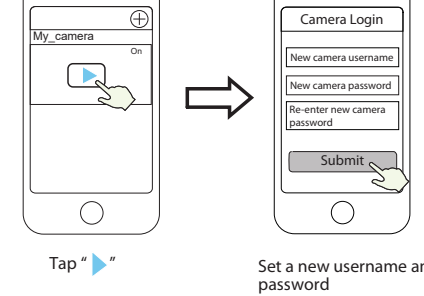

9. After completing the above steps, you can begin installing your camera.

Note: As with all network devices, it is recommended that a unique password is set, and that it is changed often for security purposes.

2. Access the area you want to be lit and the area you need camera coverage, and install your Floodlight Camera on the front wall or on the side wall. The side wall is highly recommended to get an optimal coverage for the floodlight and camera.

*The motion sensor is more sensitive to the movements across the camera field of view than movements towards or away from the sensor. We highly recommend you install the floodlight camera on the side wall.

For the best product experience, we suggested installation height of Spotlight camera: 2.5m (8.2 feet), camera downward tilt angle 15°.



1. Remove the rubber plugs indicated in the illustration below.

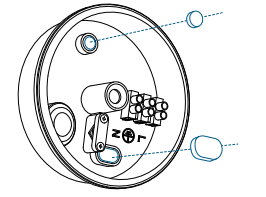

2. Run the power cable wire through the grommet and access hole.

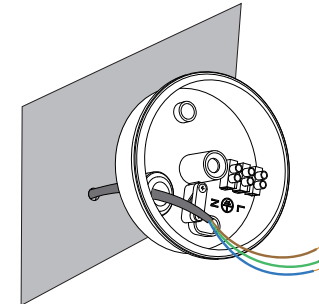

Whats in the Box?

Add device: Connection VIA the ESP Smart 2K app

WiFi Connection

WiFi Connection

Floodlight Installation

Floodlight Installation

Floodlight Installation

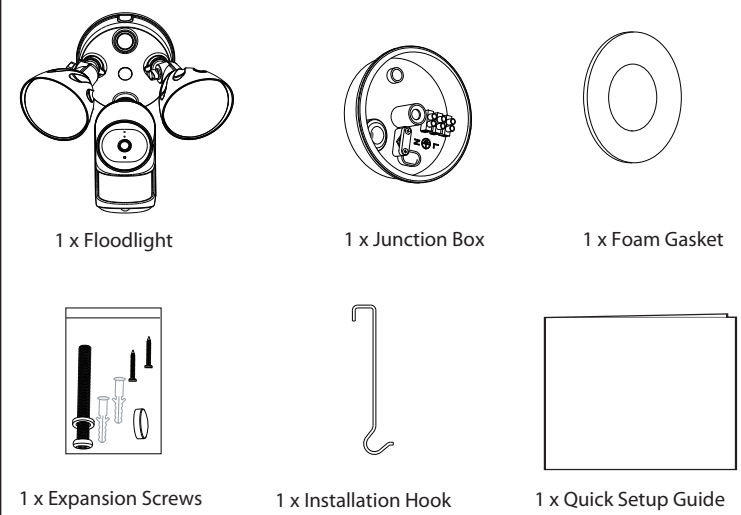

It is strongly recommended that you complete the "add devices" process on the ESP Smart 2K app before the doorbell hardware is installed.

Before You Get Started

Go onto your relevant app store and install the ESP Smart 2K App, and learn how to add the floodlight



To ensure a smoother video experience on your smart phone, following specification is recommended

- iOS: version 11 or higher.
Android: 4.1 or higher, using a device with a Graphics Processing Unit (GPU).

Note: For the best experience, please update the APP to the latest version

Tips: The camera supports dual-band 2.4GHz and 5 GHz WiFi networks, so you can choose the channel with the stronger signal to use. For example, choose your SSID: XXXXX_2.4G or XXXXX_5G.

3. Open the ESP Smart 2K APP and please sign up for an account, or sign in if you have one already.

4. After logging into your account, select "Tap to add a camera" or "+" icon on the upper right corner, then select "Scan the QR code" and scan the QR code that labelled at the bottom of your camera

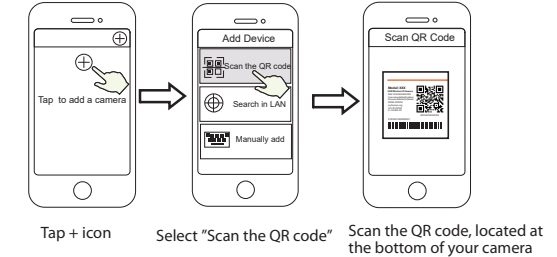

In "Add Device", if you hear "Hello", select the checkbox and tap "Next", continue to confirm that the device is in the blue flashing state, and tap "next". In "WiFi connection", enter your WiFi password and tap "Confirm" (see illustrations on the next page).

7. Wait a few seconds until the camera notifies you that the "Wireless connection succeeded", which means your camera has connected to your WiFi successfully. After, you can set the camera name and tap "Save" in "Set name" interface.

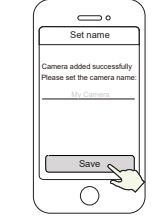

Note: If the process of adding a camera fails, please reset your camera and try adding again according to the above method. Open the port cover on the back of the camera. Press and hold the Reset button for 10 seconds.

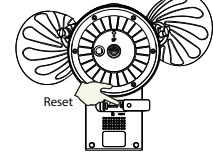

Note: Make sure you have installed the ESP Smart2K App, and have scanned the camera QR code and completed the "add device" process in the app before beginning the hardware installation process.

1. Shut power off at the breaker in your house. Switch on/off the lights to make sure the electricity in your house is properly shut off.

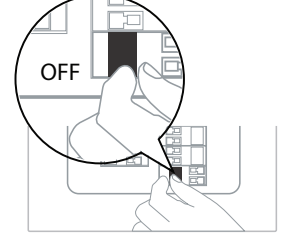

Our products are designed to comply with the recommended codes of practice for lighting and to be installed and serviced by competent persons in accordance with the relevant wiring regulations. Please Note: Product requires a 240vAC supply and is a Class 1 appliance.

On the side wall:

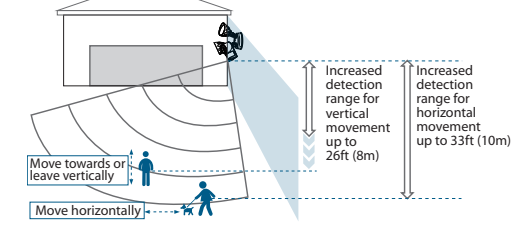

On the front wall:

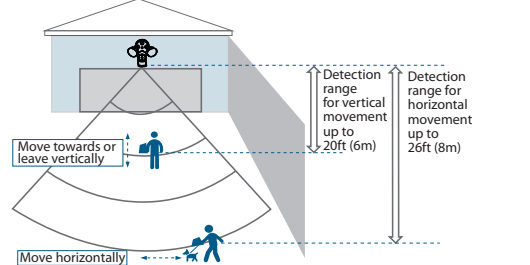

- 3. Install the junction box:
- Orientate the two mounting holes vertically to ensure stable mounting.
- On wooden walls, DO NOT pre-drill holes. Use the screws provided to fix the junction box onto the wall.

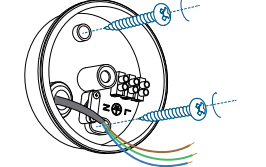

- On walls that are made out of hard materials, such as stucco, brick, or concrete, drill holes with a 15/64 inch (6 mm) drill bit, and then insert the anchors provided into the holes. Use the screws provided to fix the junction box on the wall.

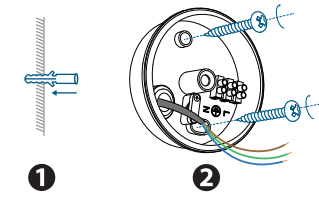

Floodlight Installation

Mounting Floodlight Camera

Mounting Floodlight Camera

Mount Floodlight Camera On the junction Box

Important Notice

Product Information

4. Unscrew the bolt with a flat-head screwdriver. Connect the Neutral (blue) / Ground (green / green and yellow) / Live (brown) wire to the Neutral / Ground / Live wire connector in the junction box respectively. Secure the wires tightly to prevent wires from falling.

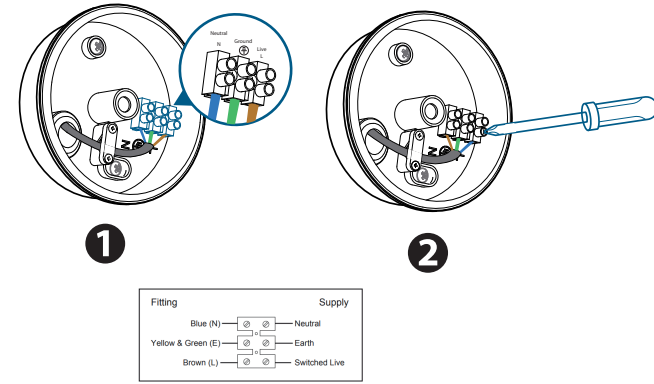

www.espuk.com

16

Peel the backing of the adhesive foam gasket and stick it to the back of the floodlight unit.

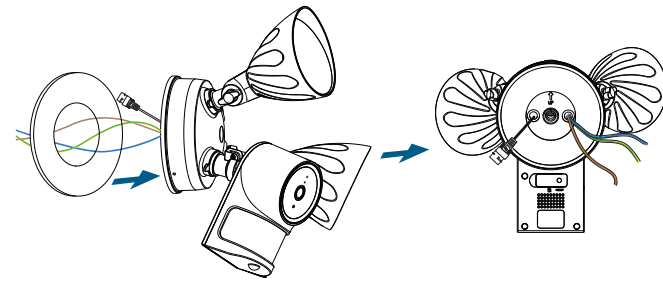

www.espuk.com

18

Connect Wires

1. Connect Ground wire from the Floodlight Camera to the Ground wire from the wire connector in the junction box.
2. Connect the Live / Neutral wire from the Floodlight Camera to the Live / Neutral wire from the wire connector in the junction box respectively.

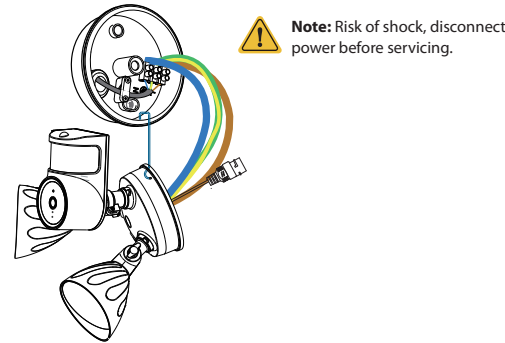

3. Secure the wires with a flat-head screwdriver.

www.espuk.com

20

1. After installation is complete, loosen the adjustment screws on the camera and floodlight to adjust the camera and light position to the desired angles.
2. Tighten the screws firmly to complete the installation.

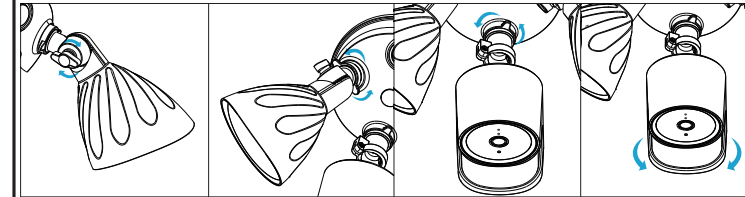

www.espuk.com

22

Camera Username & Password

The camera username & password are used to access and manage your doorbell. Having a strong password can significantly improve the security of your doorbell.

If you have forgotten either of them, please press the "Reset" button and hold it for more than 10 seconds while the camera is powered on. After hearing the voice prompt, release the button. The doorbell will automatically reboot and the default settings will be restored.

You can then reconnect the camera by following this Quick Setup Guide.

ESP Smart 2K Cloud Service Account Username & Password

Your ESP Smart 2K Cloud service account and password may be used to access both the ESP Smart 2K App and the ESP Smart 2K Cloud service website. Therefore, you can register your account username & password on either one.

Troubleshooting

- Recommended 2Mbps upload & download speed.
- For best performance, the smart-mobile device(s) need to be on Wi-Fi or 4G mobile network in order to receive maximum download speed.
- If your internet bandwidth is limited, avoid having more than two users connected simultaneously.
 - If the signal strength of your Wi-Fi router is weak, there are several ways to improve transmission:
 - Change router/camera position to receive better signal.
 - Use Wi-Fi repeater/extender to maximize the range of your Wi-Fi router

www.espuk.com

24

WLAN frequency range: 2412MHz - 2472MHz and 5725MHz - 5850MHz

Maximum transmission power (2.4GHz) : < 19dBm

Maximum transmission power (5GHz) : < 14dBm

Wireless Standard: IEEE802.11b/g/n (2.4GHz)
IEEE802.11a/n/ac (5GHz)

Power Supply: AC 100 - 240V ~ 50/60 Hz

Further product information can be found on www.espuk.com

The LEDs fitted in this product are non-replaceable.
The unit should be recycled in the correct manner when it reaches the end of its life.

WARNING : LED LAMPS ARE EXTREMELY BRIGHT. UNDER NO CIRCUMSTANCES SHOULD YOU LOOK DIRECTLY INTO AN LED BEAM. CAN CAUSE IRREPARABLE DAMAGE TO THE EYE.



www.espuk.com

www.espuk.com

26

Mounting Floodlight Camera

Mounting Floodlight Camera

Mount Floodlight Camera On the junction Box

Other ways to access your Camera

Safety Tips

Important Notice

Hang Floodlight Camera

Hang Floodlight Camera on the junction box with the hook provided.

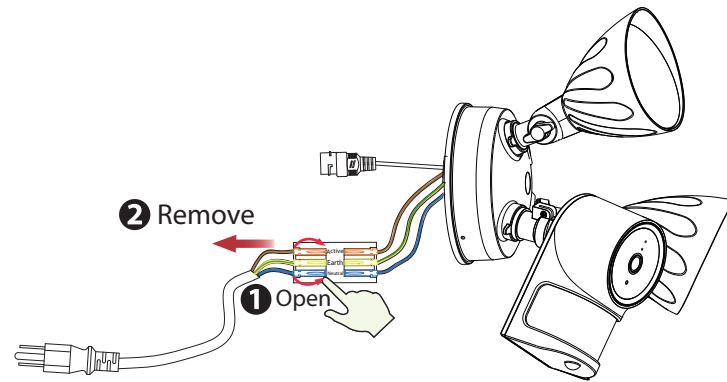

www.espuk.com

17

www.espuk.com

19

1. Align the hole on the junction box with the opening in the Floodlight Camera.
2. Screw the central screw through the center of Floodlight Camera to mount it in position.

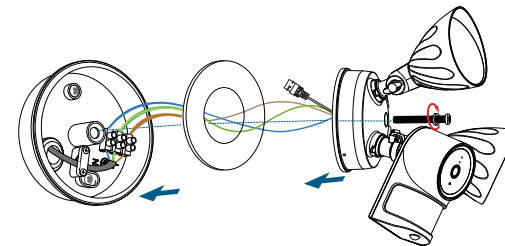

3. Cover the central screw with the central screw cap to prevent it from rusting.

www.espuk.com

21

VMSLive

VMSLive is a software packaging for PCs. It does not require plug-ins, and is compatible with Windows and Mac, supporting all ESP Smart 2K cameras; and up to 36 cameras at the same time. If you would like to manage multiple cameras, it is advised to use this software. You can download the software package at https://www.espuk.com/technical_support/product_software/

Add the Device

1. Run VMSLive, then create a local administrator account and login.
2. Tap the "+" icon on the VMSLive and follow the setup wizard to add your camera.

www.espuk.com

23

Safety Tips

- Please ensure that the proper power supply is used before using the camera.
- Please install the camera and bracket securely using the screws provided.
- Please use this product within the temperature range -4°F~122°F (-20°C~50°C). When the ambient temperature is too high or too low, it may cause product failure.
- To avoid the risk of fire or electric shock, please keep your camera connectors in a cool, dry place.
- Please keep the camera out of reach of small children.
- This product is not a toy; children should use the product under adult supervision.
- Check the logs of your camera frequently. The cameras have embedded logs telling you which IP addresses are accessing the camera.
- The floodlight source of this luminaire is not replaceable; when the floodlight source reaches its end of life the whole luminaire shall be replaced.



WARNING: This product must be installed by a licensed electrician in some countries. Check local regulations. Risk of shock, disconnect power before servicing. Contains no user serviceable parts.

www.espuk.com

25



A Scolmore GROUP
Company



Elite Security Products LTD,
Unit 7 Target Park, Shawbank Road,
Lakeside, Redditch, B98 8YN, United Kingdom

T: +44 (0)1527 515150 | F: +44 (0)1527 515143
E: info@espuk.com | W: espuk.com

www.espuk.com

26