

Remote View Door Phone

Installation and Operating Instructions

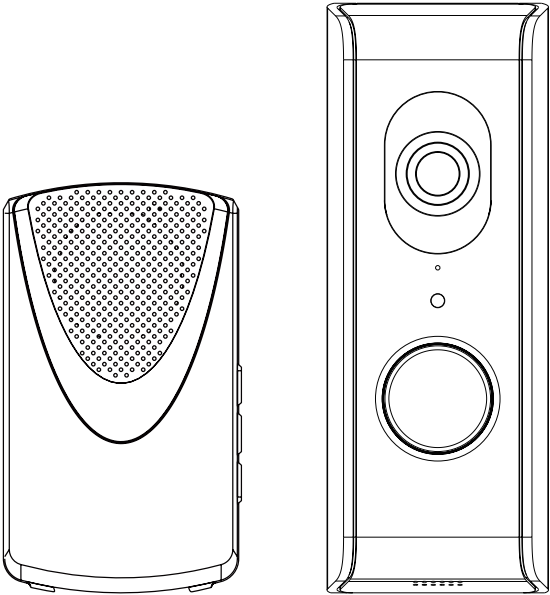

PLEASE READ THESE INSTRUCTIONS CAREFULLY BEFORE USING THIS PRODUCT
AND KEEP THIS MANUAL FOR FUTURE REFERENCE.

The state of art Remote View Door Phone (RVDP) is capable of deliver High Definition (HD) video to your smart-mobile device(s), which would require higher internet bandwidth. Due to your local internet environment condition, your mobile device(s) may display black-screen or temporary disconnect to the Remote View Door Phone (RVDP).

- * Make sure your RVDP is operating with sufficient internet bandwidth, 2Mbps (upload/download speed) are suggested.
- * For best performance, the smart-mobile device(s) need to be on Wi-Fi or 4G mobile network in order to receive maximum download speed. Actual performance will depend on the location's internet environment.
- * When the internet transmission is insufficient, your RVDP will automatically switch to Relay Mode:
 - which might have slower internet connection speed and some video / audio latency might occurs.
- * By adjusting to "Better Streaming" in the system setting section may improve the APP performance.
- * If you have limited internet bandwidth, try to avoid more than two users connecting to the RVDP simultaneously for best performance.
- * Make sure your smart-mobile device(s) is equipped with up-to-date technology, 1.5GHz dual core processor or equivalent is suggested.
- * If the signal strength of your Wi-Fi router is weak, there are several ways to improve transmission:
 - Change router/camera relative position to receive better signal.
 - Use Wi-Fi repeater/extender to maximize the service range of your Wi-Fi router.
 - Switch your router to 11b/g/n mode in order to improve router service range.
- * Please use maximum 128GB of Micro SD card XC class 10 or Micro SD card XC class 10 UHS1.
16G Mirco SD card had been pre-insert in RVDP.
- * Please note not all Android Devices can support hardware acceleration function, if your Android mobile device can not work properly, please turn off the hardware acceleration function from the APP.

CONTENTS

INTRODUCTION	2
PLEASE READ BEFORE YOU START	2
SPECIAL NOTICE OF HUMAN DETECTION FEATURES.....	3
WIRELESS DEVICES OPERATING RANGE	3
IMPORTANT SAFETY PRECAUTIONS.....	4
KIT CONTENT	6
HARDWARE OVERVIEW	7
OPERATION DIAGRAM	9
SETUP THE APP	10
MAIN PAGE OVERVIEW	11
VISITOR CALL-IN PAGE	14
EVENT VIDEO PLAYBACK	15
PLAYBACK	16
DELETE	16
DOWNLOAD.....	17
ANSWERING A CALL	18
ADVANCED SETTING	19
Admin Password	20
Device Security Code.....	21
Time Zone.....	22
Wi-Fi	22
Time Stamp.....	23
E-MAIL SETTING	24
VIDEO SETTING	25
Video Quality.....	25
Environment Mode	26
Low Light Enhancement.....	26
SENSITIVITY SETTING	27
Motion Mask.....	29
PUSH NOTIFY SETTINGS	29
SD CARD SETTING	28
Overwrite SD card.....	30
MELODY SETTING	31
UNLOCK DURATION	31
ABOUT DEVICE	32
INSTALL THE MICRO SD CARD	33
SETUP THE RVDP	34
ADDITIONAL WIRING DIAGRAMS	35
MOUNTING THE DOOR UNIT	36
PRODUCTION SPECIFICATION	37

INTRODUCTION

PLEASE READ BEFORE YOU START

Always use discretion when installing CCTV equipment, especially when there is perceived policy. Enquire relevant local regulations applicable to the lawful installation of video recording/surveillance. Third party consent may be required.

Installation Notice:

It is recommended to install the camera at the 1.3 M height above ground to have better performance of the objects detection. Please see below illustration.

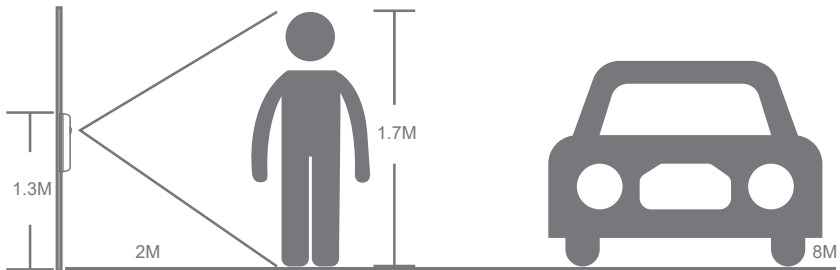

Larger objects (e.g. Vehicle) moving further away may trigger the detection.
Please adjust detection sensitivity according to the installation location.
Object Detection Range = 3M

Cautions for Use

Following tips will help the device to reduce false trigger:

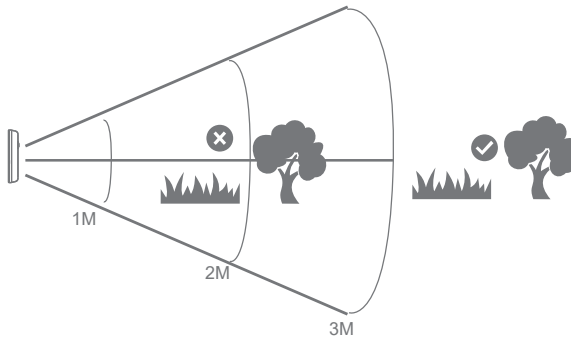

- Reduce detection sensitivity
- Keeping treetop, bushes and leaves away from the 3-meter diameter detection area
- Remove small and swaying objects that may block the viewing area

SPECIAL NOTICE OF OBJECTS DETECTION FEATURES

It is recommended to install the camera at 1.3 Meters height to have the best detection coverage. The detection effective range is 2~4 meters far from the camera.

Under certain scenario, environment, or application of the product would cause the detection not be able to function properly. Please see below for the conditions:

- (1) The detection will require the present of the moving objects in order to start the detection and start the recording.
- (2) The detection accuracy will also be limited if the object is moving in dark environment. For example, when it is completely dark at night, the person who dresses in black might affect the detection result.
- (3) To reduce false trigger, please adjust motion detection sensitivity in advance setting. In general, set to 70% or lower for 3M or shorter detection range.
- (4) If there are multiple objects moving in the camera viewing area, the detection accuracy may be reduced. Therefore, please avoid the tree leaf and bushes been picked up by the camera.

WIRELESS DEVICES OPERATING RANGE

Ensure the signal reception viewed from the wireless camera(s) is the best possible reception between the camera(s) and the Wi-Fi router. If necessary, reduce the distance between the camera(s) and the Wi-Fi router to improve overall system performance.

IMPORTANT SAFETY PRECAUTIONS

Damages caused by non-compliance with this operating manual will void the warranty! We will not assume any liability for damages to items or persons caused by improper handling or non-compliance with the safety notices! Any warranty claim will be null and void in such cases.

1. Do not drop, puncture or disassemble the camera; otherwise the warranty will be voided.
2. Avoid all contact with water, and dry hands before using.
3. Never tug on the power cords. Use the plug to unplug it from the wall outlet.
4. Do not expose the camera to high temperature or leave it in direct sunlight. Doing so may damage the camera or cause camera temporary malfunction.
5. Use the devices with care. Avoid pressing hard on the camera body.
6. For your own safety, avoid using the camera or power off the camera when there is a storm or lightning.
7. Remove the power adapter during long periods between usages.
8. Use only the accessories and power adapters supplied by the manufacturer.
9. To meet the regulations pertaining to parental responsibility, keep the devices out of the reach of infants.
10. Check power cables, do not get crushed or damaged by sharp edges whenever the devices are in operation.



Products with CE Marking comply with EMC Directive (2014/30/EU); Low Voltage Directive (2014/35/EU); RED (2014/53/EU); ROHS Directive (2011/65/EU) issued by the Commission of the European Community. Compliance with these directives implies conformity to the following European Norms:

EMC: EN 301 489

LVD: EN 62368-1

Radio: EN 300 328

DISPOSAL



If the camera system no longer functions or can no longer be repaired, it must be disposed of according to the valid statutory regulations.

Disposal of spent batteries/accumulators:

You are required by law (Battery Ordinance) to return all spent batteries and accumulators. Disposing of spent batteries/accumulators with common household waste is prohibited! Batteries/accumulators that contain hazardous substances are marked with the symbols on the side. These symbols indicate that it is prohibited to dispose of these batteries/accumulators in the household waste. The abbreviations for the respective heavy metals are: Cd=cadmium, Hg=mercury, Pb=lead. You can return spent batteries and accumulators that can no longer be charged to the designated collection points in your community, outlets or wherever batteries or accumulators are sold. Following these instructions will allow you to fulfill the legal requirements and contribute to the protection of our environment!

CAUTION

This product is designed with built-in high sensitivity microphone. Please keep the door unit away from the answering unit at least 3 to 5 meters, otherwise continuously howling will occur. Please volume down if short distance use is needed.

Do not insert or remove Micro SD Card when the system is in operation. This may cause system malfunction.

It is strongly recommended to format the Micro SD card before first use.

KIT CONTENT

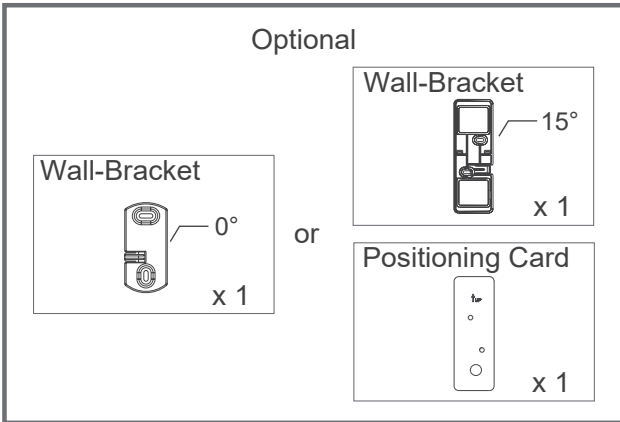
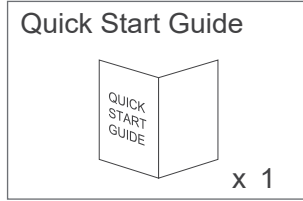
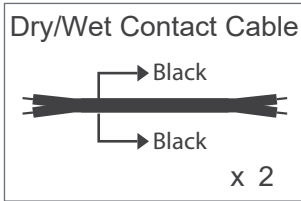
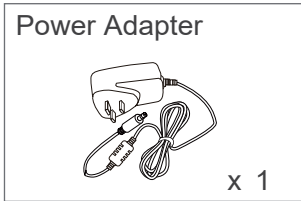
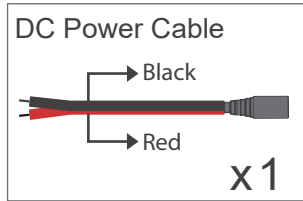
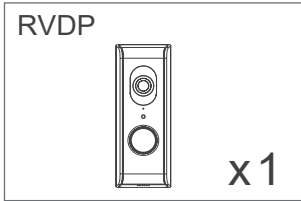

Note:

Please use maximum 128GB of Micro SD card XC class 10 or Micro SD card XC class 10 UHS1. **16G Mirco SD card had been pre-insert in RVDP.**



HARDWARE OVERVIEW

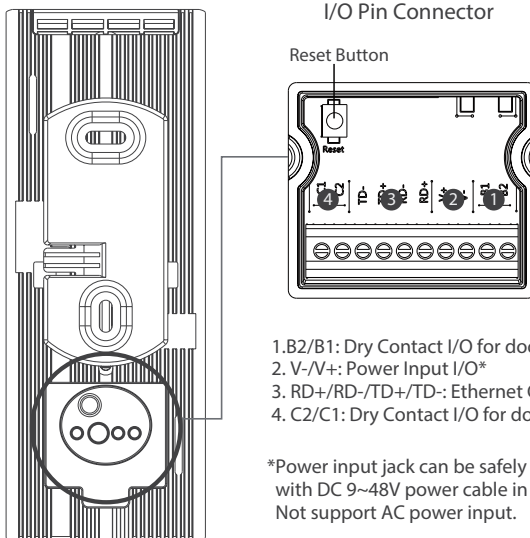
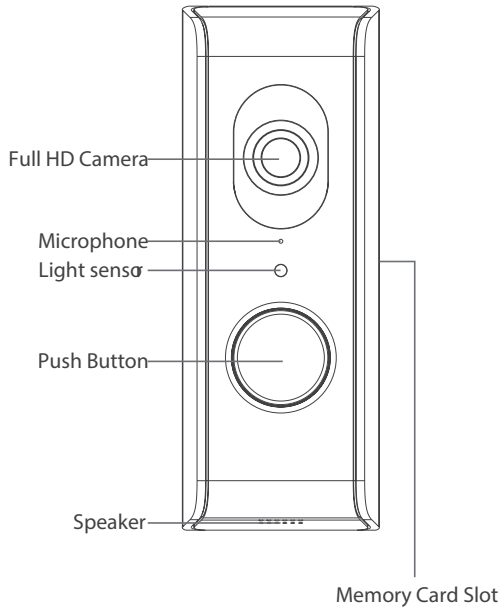

*Power input jack can be safely connected with DC 9~48V power cable in any polarity. Not support AC power input.

*Ethernet cable not included in the package.

REMOTE VIEW DOOR PHONE SETUP & INSTALLATION

! BEFORE YOU START

- Do not mount the RVDP until completing the Wi-Fi connection setup.
- Install the RVDP where it can receive excellent Wi-Fi network signals. Under weak Wi-Fi signal environment, install the RVDP by using Ethernet cable.
- First connect power to the RVDP using the supplied Power Input Cable to 9-48V power source.
- After supplying power, the boot up process will begin (> 2 minutes), the circle LED will repeatedly flashes 3 times after the boot up process is completed (please press and hold the “Reset” button for 5 seconds to reset if the LED does not flash).

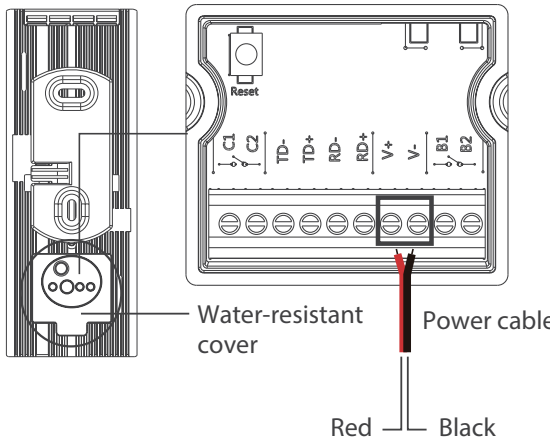

OPERATION DIAGRAM

The Remote View Door Phone (RVDP) is designed to deliver live video directly to your smart mobile devices after visitor have pressed the communication button on the door unit. The RVDP app will allow you to see live video, speak to the visitor, manually capture snapshot/video and even open the door (3rd party door lock device required) for the visitor.

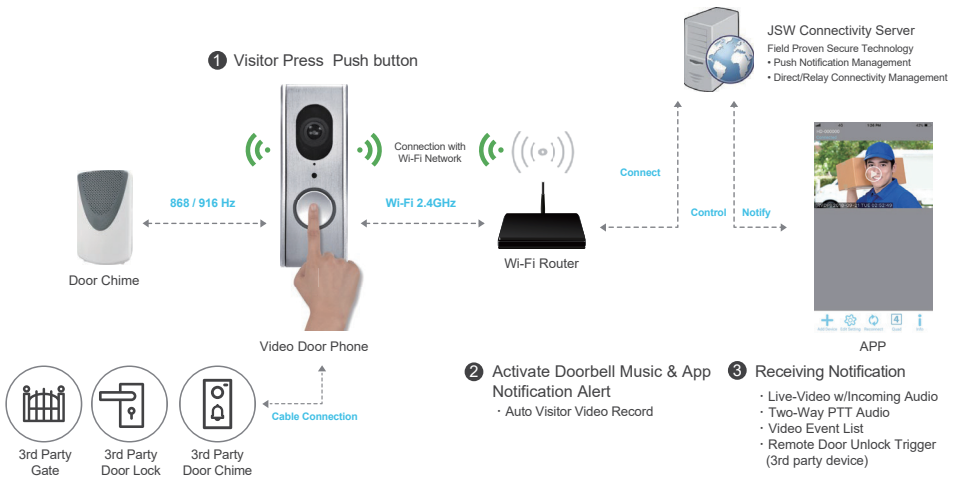

Note:

If you have changed the Wi-Fi or wish the camera could connect to different router, please remove the camera from the device list first and reset the camera to default. Follow the installation process and setup as new camera.

SETUP THE APP

Please download and install the "ESP Smart" APP to your device.

Search the app in the App Store or Google Play.

Download and open the app. The app will guide you step-by-step through the install.



ESP Smart

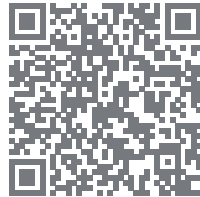

MAIN PAGE OVERVIEW

The MAIN PAGE section offers you an overview for RVDP and access to different management functions.

MAIN PAGE



(iOS)

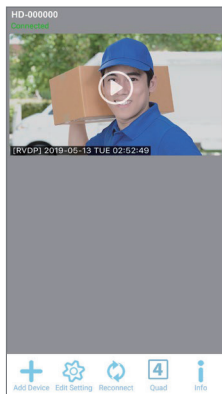

(Android)

List of all registered RVDP. You can quickly access preferred RVDP in the list even when multiple RVDP are registered by scrolling the list up or down.

Tap the camera to enter Live-View.

The Connection Status (Connected or Disconnected) is indicated for each RVDP in the list.



Add Device

Add RVDP: To add RVDP.



Edit Setting

RVDP Setting: Access point for "RVDP Information (enter to find "Advanced Setting Section" and "Wi-Fi Reset)", "RVDP Delete" and "Event List".



Reconnect

Refresh: Refresh connections of all the RVDP in the list.



Info

Information: Access RVDP/App firmware version information and app PIN Lock setup.



Quad

Quad: Select the devices and click the icon to combine the devices liveview into same image (It is available for more than 1 devices).

ADD RVDP

Tap  to add RVDP. Please refer to page 10 "APP Setup" section for more details.

SETTING

Tap  and additional setup selection icons will appear. Tap  to exit.

Additional setup selection

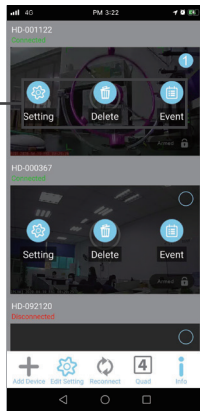

(iOS)

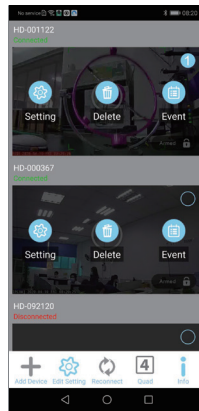

(Android)



Setting

RVDP INFORMATION: Change RVDP name, reset Wi-Fi router setting and access Advanced Setting section.



Delete

DELETE RVDP: Remove the RVDP.



Event

EVENT LIST: View and playback the list of motion triggered event(s) for the particular RVDP.



In case more than 1 pcs devices, select  on the top left and click the Quard icon. The devices liveview will be combined into one image.

SETUP PIN LOCK

MUST enter PIN code when you have enable PIN lock function with launching the APP.

1. Enable "Enable lock when starting" and enter your PIN code.
2. Confirm PIN code entered.

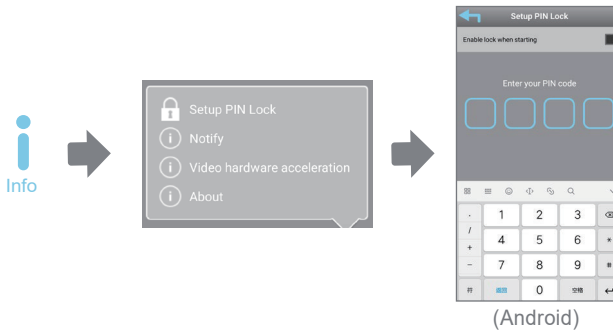
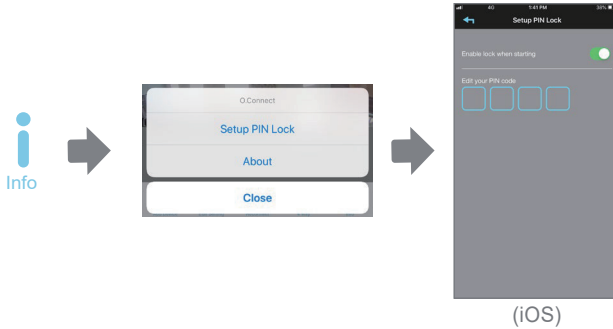

Note:

If you forgot the PIN code, please delete and reinstall the app.

ABOUT APP/API VERSION INFO

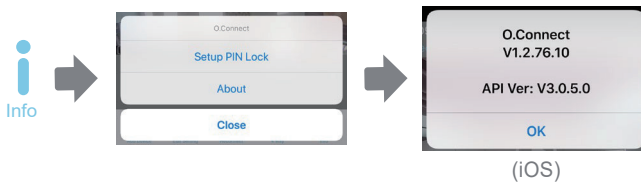

Tap the ABOUT icon to check the APP Version when necessary.



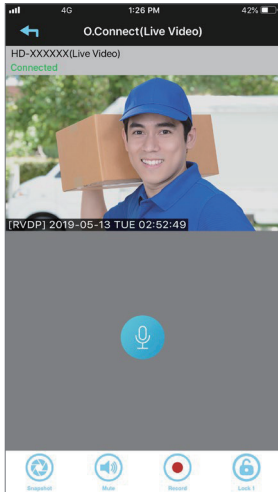

VISITOR CALL-IN PAGE

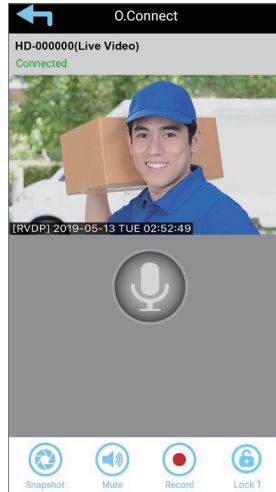

(iOS)



(Android)

	Press to talk and release to listen	Tap and hold the icon to speak with visitor
	Snapshot	Tap to take a picture. Pictures are saved to your mobile device
	Mute/Unmute	Tap once to mute the audio coming from the door unit. Tap again to resume
	Record	Tap to trigger recording function from door unit. The recorded files are stored in the memory card inside the door unit
	Lock 1	Tap the icon once and enter "admin password" to remotely open the door for visitor (3rd party device required)

EVENT VIDEO PLAYBACK

The recorded video is automatically saved to the memory card. You can remotely access the file(s) for playback.



Tap **Edit** on the main page.



Tap **Event** and the Date-Time filter would appear. User may define the period for system to display all available recorded file(s) for playback.

For playback, select the file from either local or cloud event section. During the playback you can tap the Pause icon to pause/resume the playback. The local network environment condition (example: upload/download speed) may cause improper video playback, such as black screen. When it happens please leave the playback mode and try again later when the internet condition improved. We strongly suggest that using Wi-Fi for better performance playback.

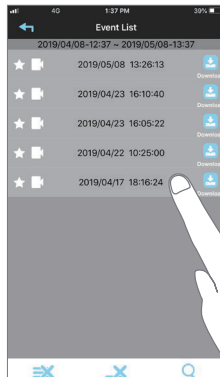
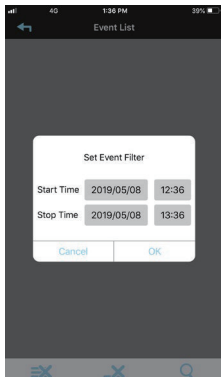

Tap once for playback, tap the download icon to download the file to mobile device.

PLAYBACK

When you record a video clip from your camera. You can pause/play the video during the playback, to deactivate/activate the audio function.

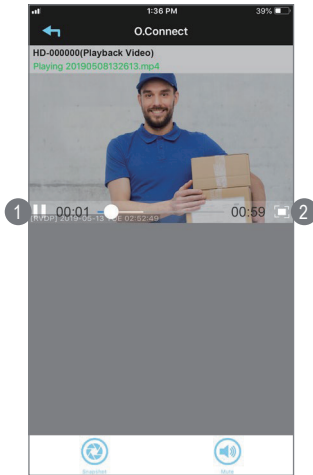

1. Tap to pause/play video
2. Tap to view full screen

DELETE

Tap the edit icon, then select the file(s) you would like to delete from list.

1. Select the video you want to delete
2. Then tap the trash can icon

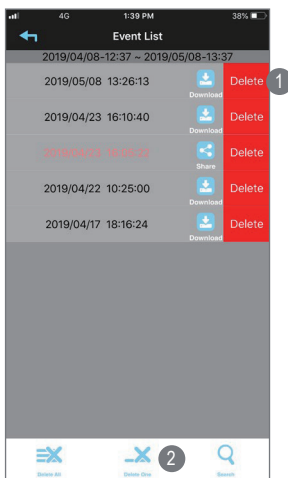

(iOS)

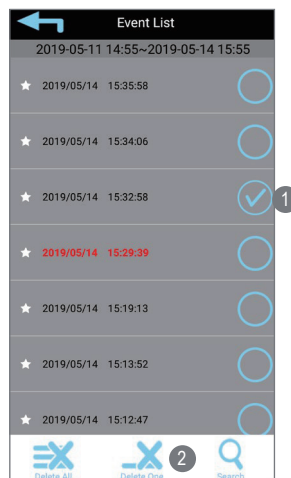

(Android)

DOWNLOAD

Press the download icon to download the file, and you can share the video by the third party app or save the file onto the mobile device.

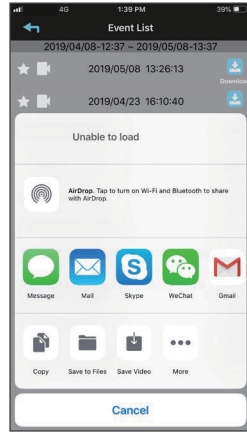

(iOS)

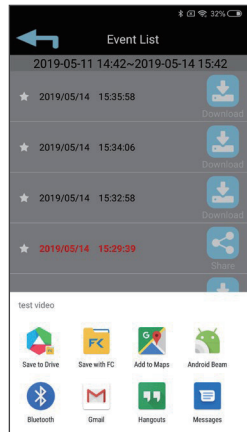
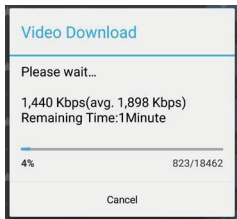

(Android)

Note:

During the download process, the system will stop both the live view and recording functions. APP will automatically inform any user accessing the camera that the system is busy and the connection has been terminated.

ANSWERING A CALL

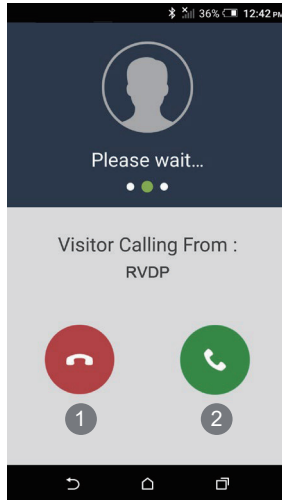

Above screen would appear When visitor pressed the bell button.

1. Ignore the communication request.
2. Accept the communication request.

Note:

For iOS user, due to the system fundamental structural design, you will have to confirm/accept incoming communication request via pop-ups first before the answering section would appear. For more details, please refer to the manual.

ADVANCED SETTING

This chapter explains the advanced settings for administrator. Administrator is the one who owns the administration password and has the full control to the WAPP camera. The administrator can access all WAPP functions and settings, while general users can receive the surveillance images for live view/screen capture/video recording and may not manage the camera settings.

Admin Password	The security code required to enter Advanced Setting for system setting management
Device Security Code	Setup/Change the password for remote access
Time Zone	Setup the appropriate time zone
Sensor Setup	Setup the doorchime or other sensor devices
Wi-Fi	Manage your Wi-Fi Network
Time Stamp	Select a color for the tab of time
E-mail Setting	Setup your email account for E-mail alert
Video Setting	Configure the video quality and local power frequency, and low light enhancement.
Sensitivity Setting	Setup the doorbell sensitivity for motion detection
Push Notify Settings	Activate/Deactivate push notification function for the device
SD Card Settings	Format/Setup overwrite the SD card
Melody Setting	Mange doorbell melody and volume
Doorchime Setting	Setup the door chime type
Unlock Duration	Setup the length of time the trigger
About Device	Check the App and API Kernel version

Admin Password

The Admin Password is a specific security code for the administrator to change the advanced settings. The default admin password is 123456.

This function allows you to change the default admin password into your personal admin password. For the protection of your system configuration, you need to enter the admin password when changing the advanced settings. We strongly suggest that you change the admin password periodically.

Note: If you forgot admin password, press and hold the reset button for 5 seconds to restore the device to factory default setting. (refer to the product overview section). And configure your device from the start.

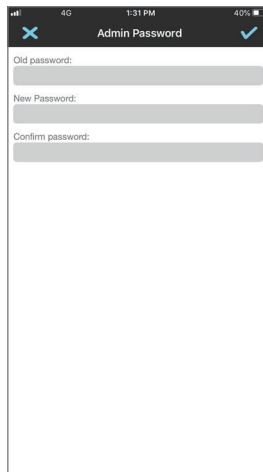

The screenshot shows a mobile application interface for changing the admin password. At the top, the status bar displays '4G', '1:31 PM', and '40%' battery. The app header is titled 'Admin Password' with a blue 'X' icon on the left and a blue checkmark icon on the right. Below the header, there are three input fields: 'Old password:', 'New Password:', and 'Confirm password:'. Each field is represented by a grey rectangular box. The rest of the screen is blank white space.

Device Security Code

This section allows you to setup the security code, limiting who can access to the device form aremote location.

The default password of the camera is 123456, you can enter character a~z, A~Z, 0~9, “_”, “-”, “!”, “#”, “\$”, “%”, “*” with max 31 characters.

Please use this function to change the default password into your personal security code.

Note: If you forget the Device Security Code, press and hold the reset button for 5 seconds to reset the system to factory default. And configure the device from the start.

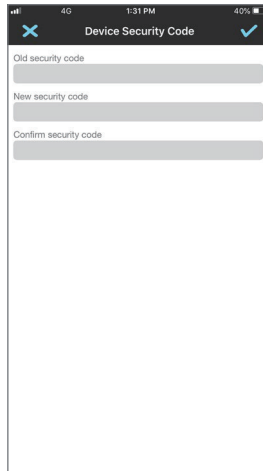



The screenshot shows a mobile application interface for setting a device security code. At the top, the status bar displays '4G', '1:31 PM', and '40%' battery. The app title is 'Device Security Code'. Below the title are three input fields: 'Old security code', 'New security code', and 'Confirm security code'. Each field is currently empty and has a grey background. There are blue 'X' and checkmark icons in the top left and right corners of the app window, respectively.

SETUP THE DOOR CHIME W/ VIDEO DOOR PHONE

Please follow the setups in case accidentally delect the doorchime in the advanced setting.

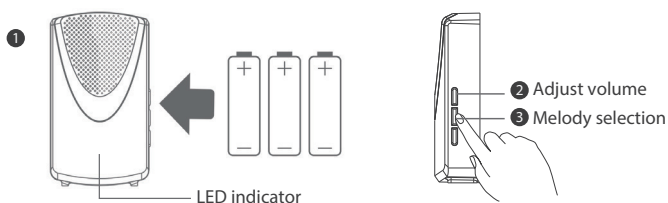
- (1) Insert three pieces of AA batteries into the Door Chime.
- (2) Adjust the desired volume of Door Chime by pressing the volume key on the side of the Door Chime.
- (3) Select the desired melody by pressing the melody key on the side of the Door Chime.



- (4) Open APP and go to advanced settings, and chooes Sensor Setup, then tap  and tap Door Chime icon.
- (5) Remove and reinsert the batteries into the Door Chime to start pairing process (you have 30s to complete this action), then blue LED will flash until pairing is complete.
- (6) Once the Door Chime has paired to the video door phone; Door Chime will ring with the rington melody which you have chosen, showing the paring is now completed.
- (7) Name your device and tap "Next" to complete the pairing.

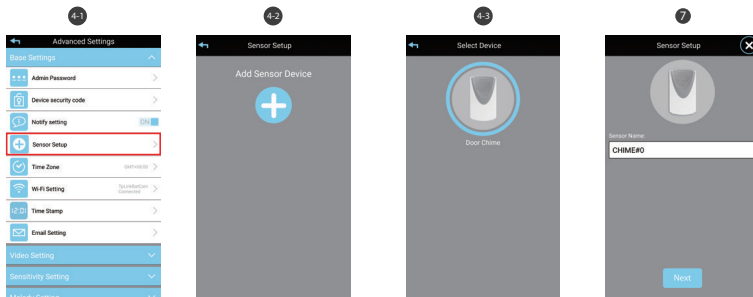

Time Zone

The drop-down list shows the world time zone. Select the time zone that will work the best for you. If your date/time is during the daylight saving time period, please check the Daylight Saving box to adjust the system time properly.

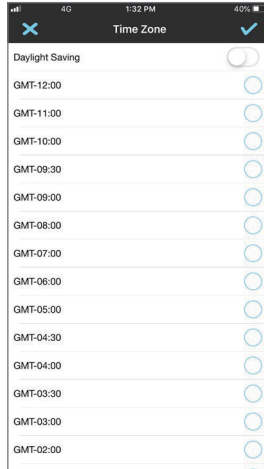

Wi-Fi

The Wi-Fi setting allows you to choose the wireless connection and setup the Wi-Fi environment. When you tap the “Manage Wi-Fi network” button, the system automatically scans the nearby network and shows the available Wi-Fi routers in the drop-down list. Choose the appropriate Wi-Fi router and enter the Wi-Fi router password if necessary. Due to security concerns, it is suggested to use the WPA/WPA2/ WPA2-PSK protocol for Wi-Fi network.

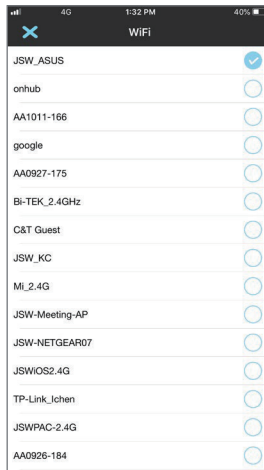

Time Stamp

This section allows you to change the time stamp background color. And drag and drop where you want to place the time stamp.

Place the time stamp.

1. The time stamp locates at the corner where you tap.
2. Tap to change the time stamp background color.

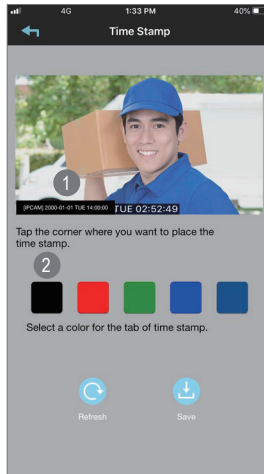

E-MAIL SETTING

The email setting allows you to configure the email environment, email account and password. Gmail account is suggested.

Click the “Use SSL” check box will transmit the data in encryption. This setting requires the Simple Mail Transfer Protocol (SMTP) configuration. Most ISPs use the SMTP method to transfer outbound mail via the internet. Only use the SMTP that supports SSL.

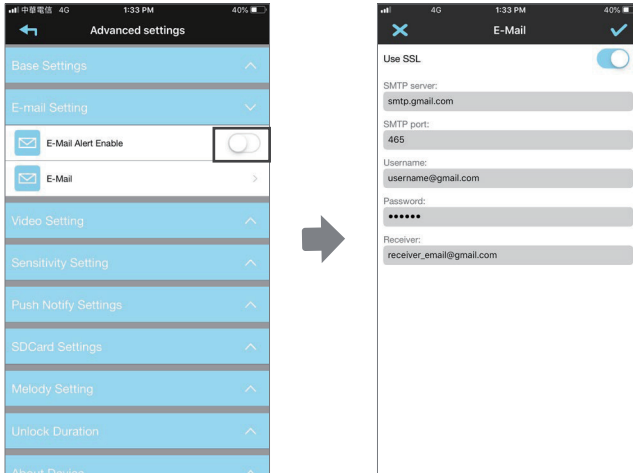

Gmail Setting (suggested)

SMTP Server	smtp.gmail.com	Enter the gmail SMTP server
SMTP Port	465	Enter the SMTP port 465
Username	XXX@gmail.com	Enter your email address
Password	XXXXXXXX	Enter the password for this gmail account
Email to	XXX@gmail.com	Enter the email address for the recipient who receives the email alert.

VIDEO SETTING

This section allows you to configure the video quality and environment mode.

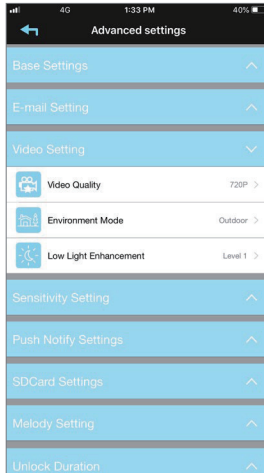

Video Quality

The Video Quality setting section allows you to adjust the video streaming to the app with options of 1080P, 720P, and VGA.

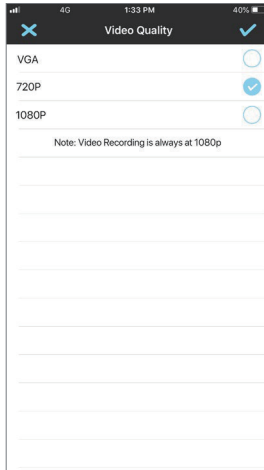

Environment Mode

The Environment Mode settings allows you to select the power line frequency used at the location of the camera. The power line frequency varies depending on geographic region. It may cause image flicker if wrong frequency is selected. Please check with local authorities for proper setting.

There are two type video color tone, user can change the video color tone between warmyellow(indoor) and cool-white (outdoor).

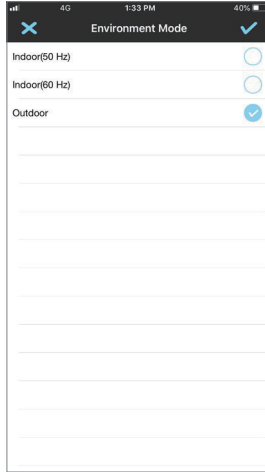

Low Light Enhancement

The Low Light Enhancement Mode is for improving the night view video image by providing 5 levels to select from (5 = brightest).

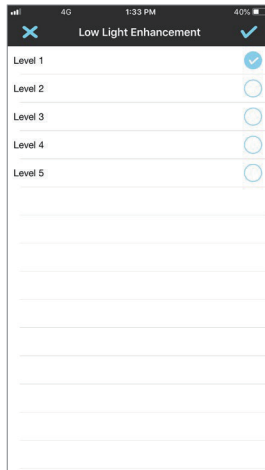

SENSITIVITY SETTING

Software use advance software analysis to trigger motion alarm.

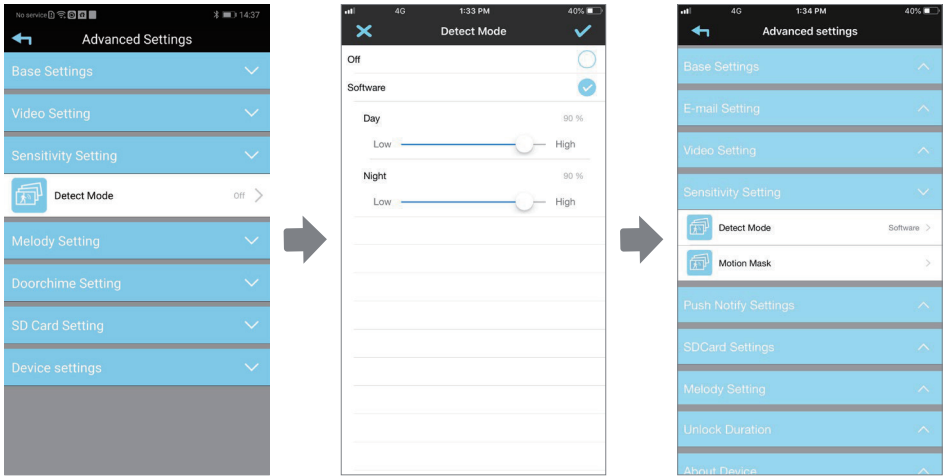

Motion Mask

This function allows you quickly select motion mask from 3 default model. In addition to, the user is able to tap screen which area you don't want to be detected.

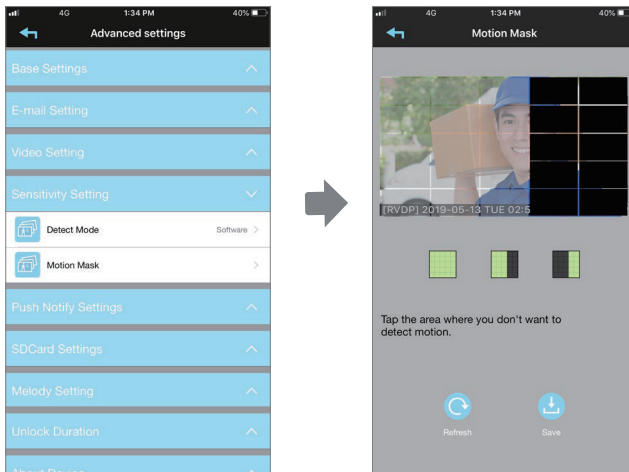

DOORBELL SETTING

This setting is provided for the connection of your existing wired door chime. The function supports mechanical chime only. By wiring up the dry contact wires from the back of camera. You can allow the wire chime to ring the host. Set "MUTE" to mute the chime, set 1 sec-3 sec to control the duration of the chime sound.

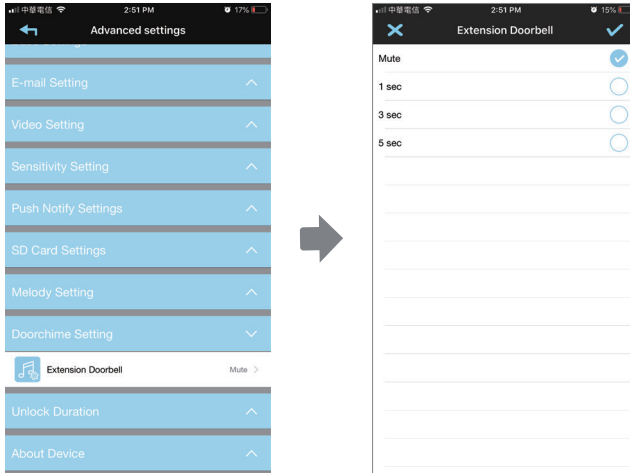

PUSH NOTIFY SETTINGS

By disable the notification alert here all user will not be able to receive push notification on their smart-device, even if they have push notification enabled.

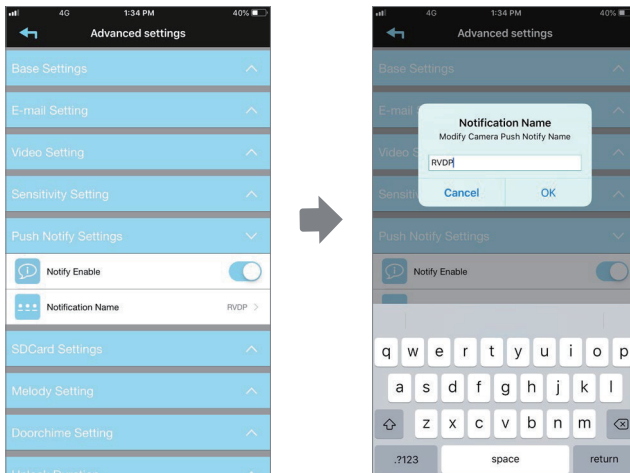

SD CARD SETTING

Formatting your memory card will **ERASE** all the data from it and you will not be able to get the data back. Please back up your video files **BEFORE** formatting the memory card.

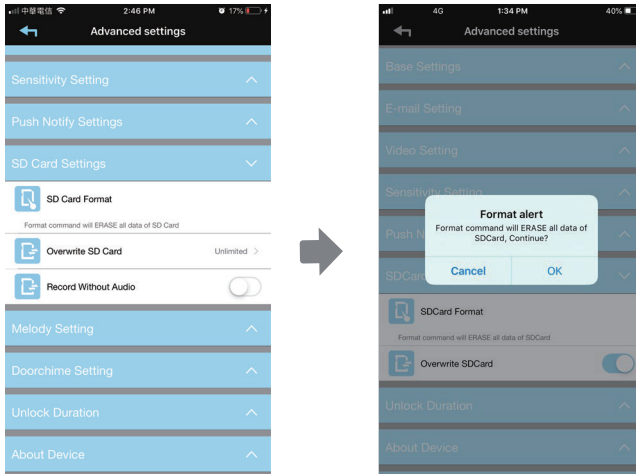

Note: The system is optimized to Class 10 memory card. Memory card with lower specification will decrease the recording and playback function efficiency. During format process, all recording & viewing will stop until format process completes.

Overwrite SD card

This function will overwrite the oldest files when the micro memory card is full. Turning on this function will enable the system to start overwriting the old files when the available memory card capacity is not enough. This ensures the most up to date video recordings can be saved so that you won't miss any important information.

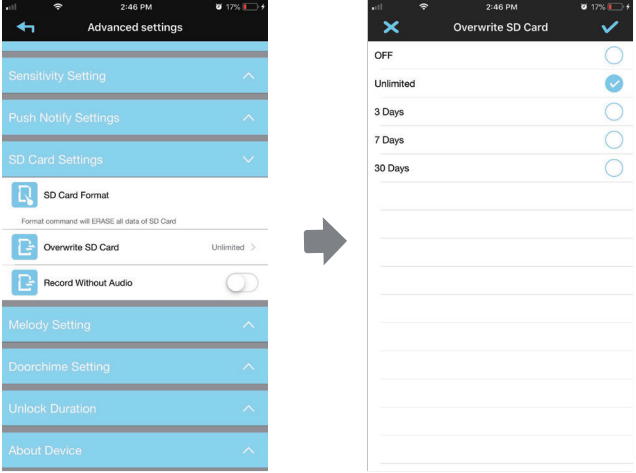

Note:

You will want to reformat the memory card from time to time to ensure the condition of the storage device. Your camera system will not work properly if the memory card become corrupted.

Record without audio

This function would allow you to make video only recording (without audio).

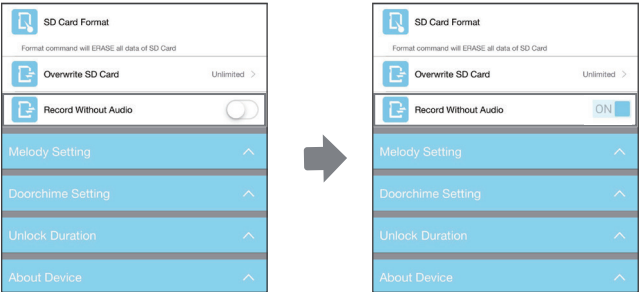

MELODY SETTING

Mange doorbell melody and volume.

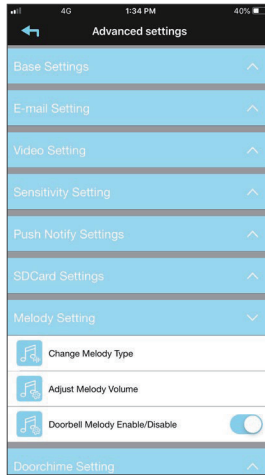

UNLOCK DURATION

This section allows you setup the length of time the trigger for door. According to different device to setup the duration. (1, 3, or 5 seconds).

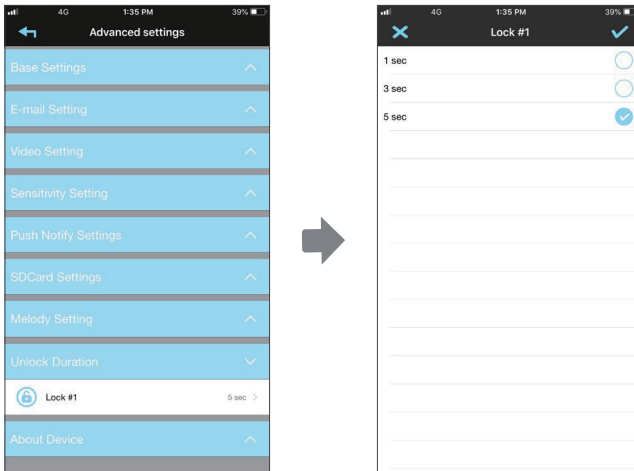

ABOUT DEVICE

This section shows the device information about the including device version, total size and available size of the memory card.

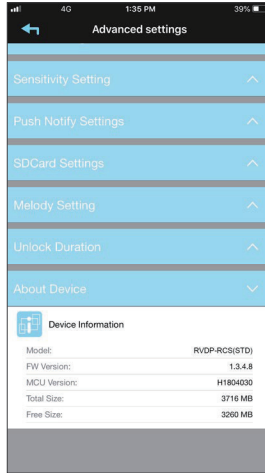

INSTALL THE MICRO SD CARD

1. Please remove the screws and rubber cover in the back of the metal housing first.
2. Slid the metal housing down and camera up to separate the camera with back cover.
3. Remove the rubber cover of the Micro SD Card slot on the left side of the camera.
4. Insert the Micro SD Card and put back the rubber cover.
5. Slide the metal bracket back to upright position.

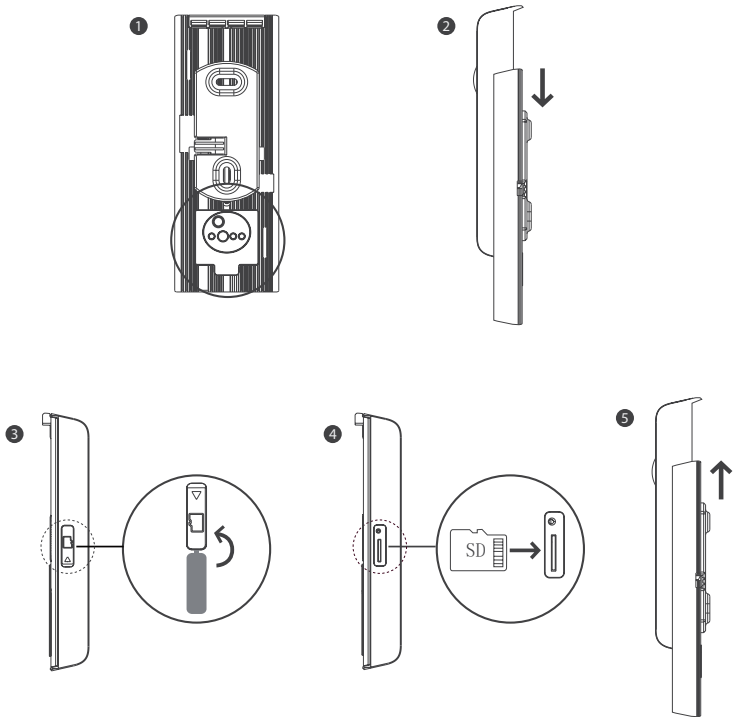

SETUP THE RVDP

1. Fasten the wall-mount bracket to the wall by using 2pcs screws provided.
2. Connect power cable to the power input I/O pins by through the water-resistant cover.
3. Place the device on the wall-mount bracket.
4. After supplying power, the boot up process will begin (> 2 minutes), the circle LED will repeatedly flashes 3 times after the boot up process is completed (please press and hold the "Reset" button for 5 seconds to reset if the LED does not flash).

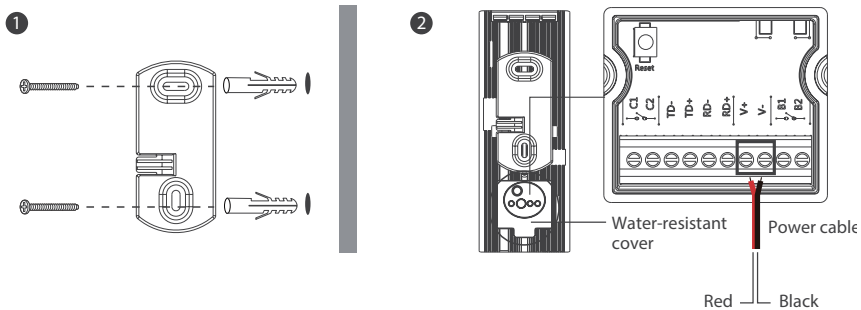

Note:

For how to connect RVDP with existing doorbell wires, electronic lock/gate, please refer to "Additional Wiring Diagrams" section.

ADDITIONAL WIRING DIAGRAMS

A. Ethernet (Wet supplier)

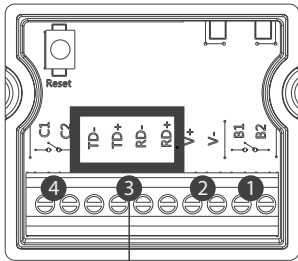

Connection	Cable Color
Tx +	Orange / White
Tx -	Orange
Rx +	Green / White
Rx -	Green



B. Existing Bell Wiring

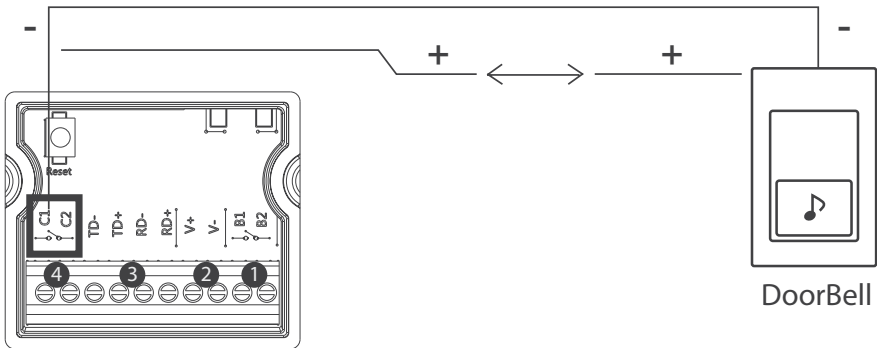

C. Electronic Gate (2/4-Wire Type Connection)

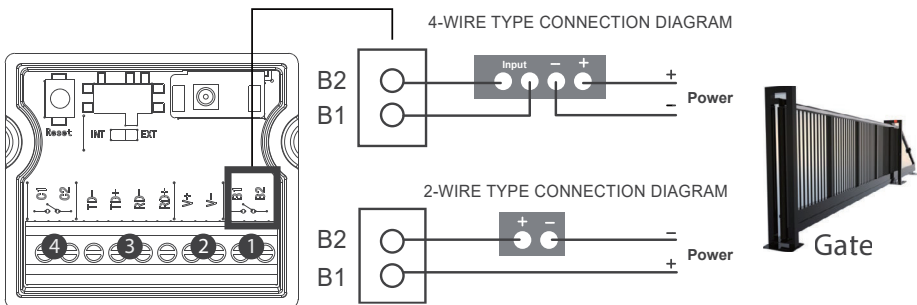

MOUNTING THE DOOR UNIT

Do not mount the RVDP until you have completed the Wi-Fi connection setup and have all the wiring process completed. It is best to test the camera function properly with app prior mounting the door unit.

Please make sure the installation location is free from moisture and wires are not exposed in any form.

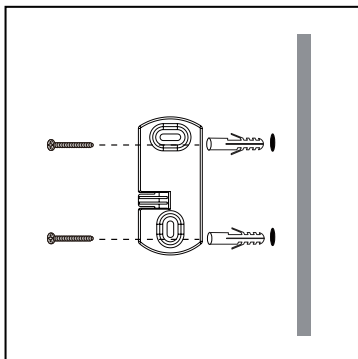

Step 1

Confirm position and mount the bracket via the screws supplied.

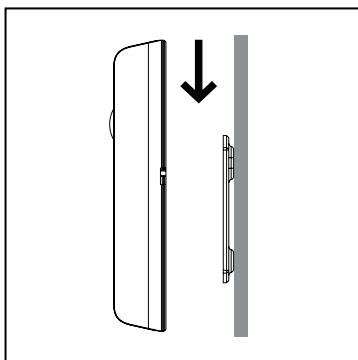

Step 2

Place the device on the mounting bracket.

PRODUCTION SPECIFICATION

Connectivity	Wi-Fi 802.11b/g/n + Ethernet connection
Transmission Frequency	2.4GHz
Transmission Range	Up to 150 Meters (LoS)
Image Sensor	1080P
Video Compression	H.264
Two-Way Audio	Yes
One-Way Video	Yes
Push Notification	Yes / iOS and Android
Event List	Yes / Snapshot and Video
Playback	App / iOS and Android
Night Vision	5M
Field of View	140°
People Detection	Supported
Audio Input/output	Speaker & Microphone
Video Resolution	1080P/720P/VGA
Video FPS	Up To 20 FPS
Data Storage	Micro SD Card up to 128GB
Door Bell Melody	3 Selectable from APP
IP Rating	IPX5
Wired relay	Optional 1 set of dry contact relay for door lock trigger
Power Option	DC Power
Operating Temperature	14°F/-10°C ~ 104°F/40°C
Dimension	166mm (H) x 50mm (W) x 24mm (D)